

# Wailuku Warehouse Space

920 Eha Street

## FOR SUBLEASE

AREA: 19,525 sq.ft. Warehouse

1,525 sq.ft. Office

1,525 sq.ft. Upstairs Office

TOTAL AREA: 21,975 sq.ft (est)

BASE RENT: \$0.90 per sq.ft. NNN until 1/31/18

\$0.93 per sq.ft. NNN until 1/31/19

\$0.95 per sq.ft. NNN until 1/31/20

NET OPERATING EXPENSE: \$0.15 per sq.ft.

Sublease until 1/31/2020

2 Loading areas

Roll -up doors

38 on-site parking stalls (1/600sf)

Longer lease term available to qualified tenant

Maybe subdivided to 8,000 sq.ft.



*Exclusively Offered By:*

**Ben Walin, CCIM R(B)**

[bwalin@ccim.net](mailto:bwalin@ccim.net)

808.244.2200



**COMMERCIAL PROPERTIES**  
OF MAUI

444 Hana Highway

Suite C

Kahului, HI 96732-2315

[mauibiz.com](http://mauibiz.com)

# Site Plan

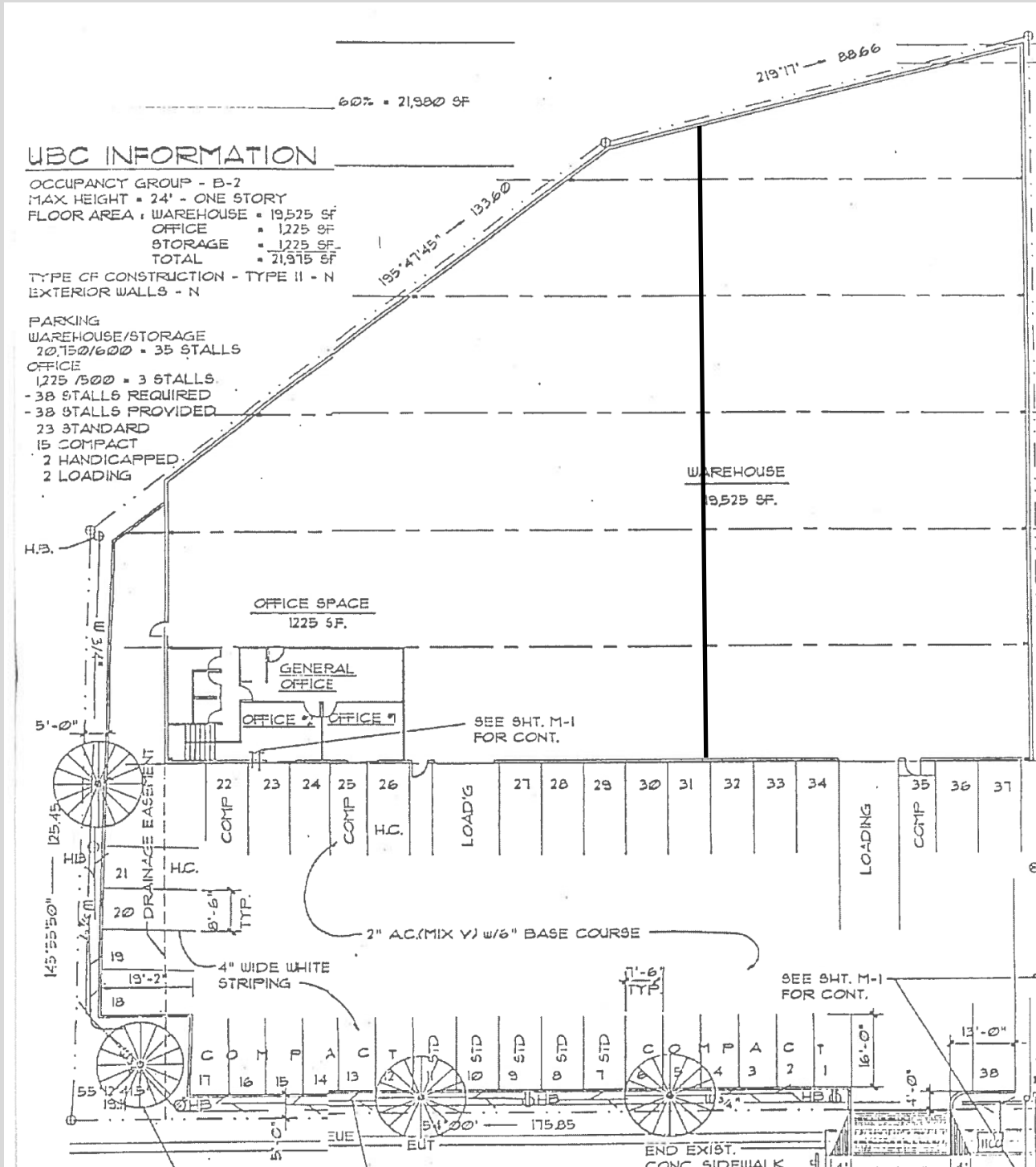

**Exclusively Offered By:**  
**Ben Walin, CCIM R(B)**  
[bwalin@ccim.net](mailto:bwalin@ccim.net)  
 808.244.2200



**COMMERCIAL PROPERTIES**  
 OF MAUI

444 Hana Highway  
 Suite C  
 Kahului, HI 96732-2315  
[mauibiz.com](http://mauibiz.com)